

**MATERIAL TABLE**

BODY	DISC	SEAT	STEM	END COVER
DUCTILE CAST IRON	304SS, 316SS, 316L	EPDM	416SS	DUCTILE CAST IRON
GRAY CAST IRON	1.4469, 1.4529	NBR	45#	GRAY CAST IRON
	Ductile iron C95400			

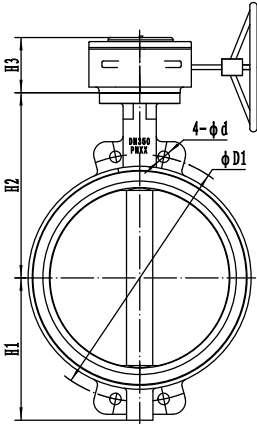

Ø350mm

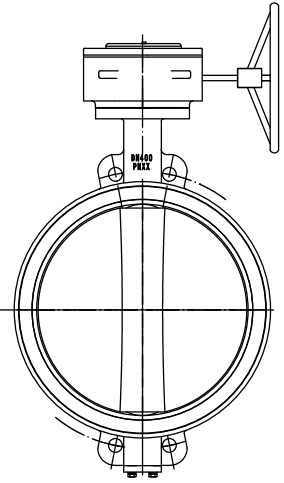
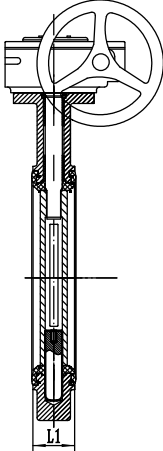

Ø400-450mm

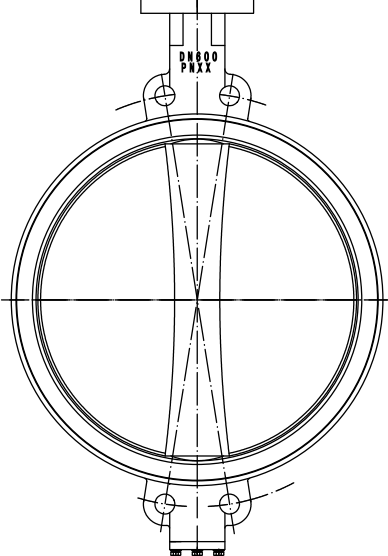
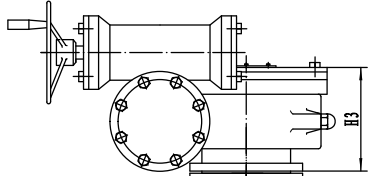
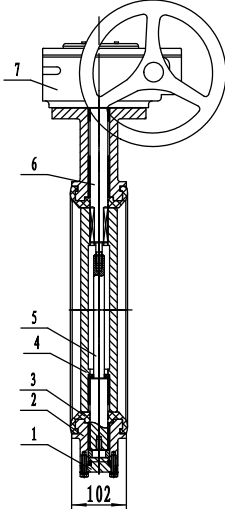

Ø500-600mm

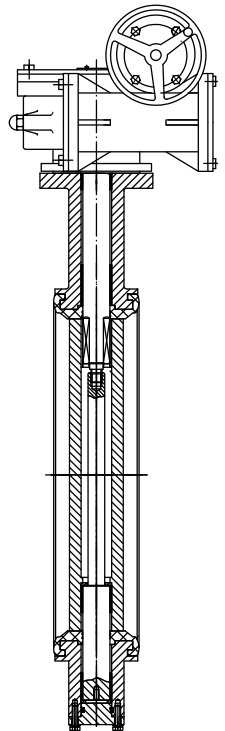

Size	L1	φ D1	4-φ d	H1	H2	H3
350mm	77.6	460/470	4-22/4-26	265	345	85
400mm	102	515/525	4-26/4-30	310	377	125
450mm	114	565/585	4-26/4-30	343	412	125
500mm	127	620/650	4-26/4-33	379	440	110
600mm	154	725/770	4-30/4-36	470	562	128

Remark: Working pressure PN10/16, Flange standard according to GB/T 9113.1-2000.

MAX WORKING PRESS	10 / 16 bar
SHELL TEST	15 / 24 bar
SEAT TEST	11 / 17.6 bar
TEST FLUID	Water

7	WORM GEAR	1	HT200
6	UPPER STEM	1	SEE MATERIAL TABLE
5	LOWER STEM	1	
4	DISC	1	SEE MATERIAL TABLE
3	SEAT	1	
2	BODY	1	
1	END COVER	1	
ITEM NO.	PART NAME	Q'TY	MATERIAL



北京好利阀业集团有限公司  
Beijing HAOLIFA valve group manufacturing CO., LTD.

DESN BY    CHK BY    AUTH BY    ISSUE DATE

MATERIAL

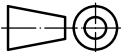

SCALE

UNIT    mm

270D-PN10/16 BUTTERFLY VALVE

Ø350mm ~ 600mm WORM GEAR OPERATED

SIZE A4

DRAWING NO.

REV